

5 MB 1/50

FOUND 3/4" IP  
TAGGED 13512

DRAINAGE  
AND OPEN  
SPACE  
EASEMENTS

DRAINAGE  
AND OPEN  
SPACE  
EASEMENTS

DRAINAGE  
AND OPEN  
SPACE  
EASEMENTS

FOUND 3/4" IP  
TAGGED 13512

RESIDENTIAL  
DEVELOPMENT  
PROHIBITED WITHIN  
THE NORTHERLY 186'  
FEET OF PARCEL 1

VALLEY VIEW ROAD

PARCEL 1  
PM 37-172  
GROSS 4.44± AC.  
NET 4.41± AC.

PARCEL 1

FOUND 2" I.P.  
TAGGED "LS 4587"

SET 5/8"  
REBAR & CAP  
TAGGED "LS  
4587"

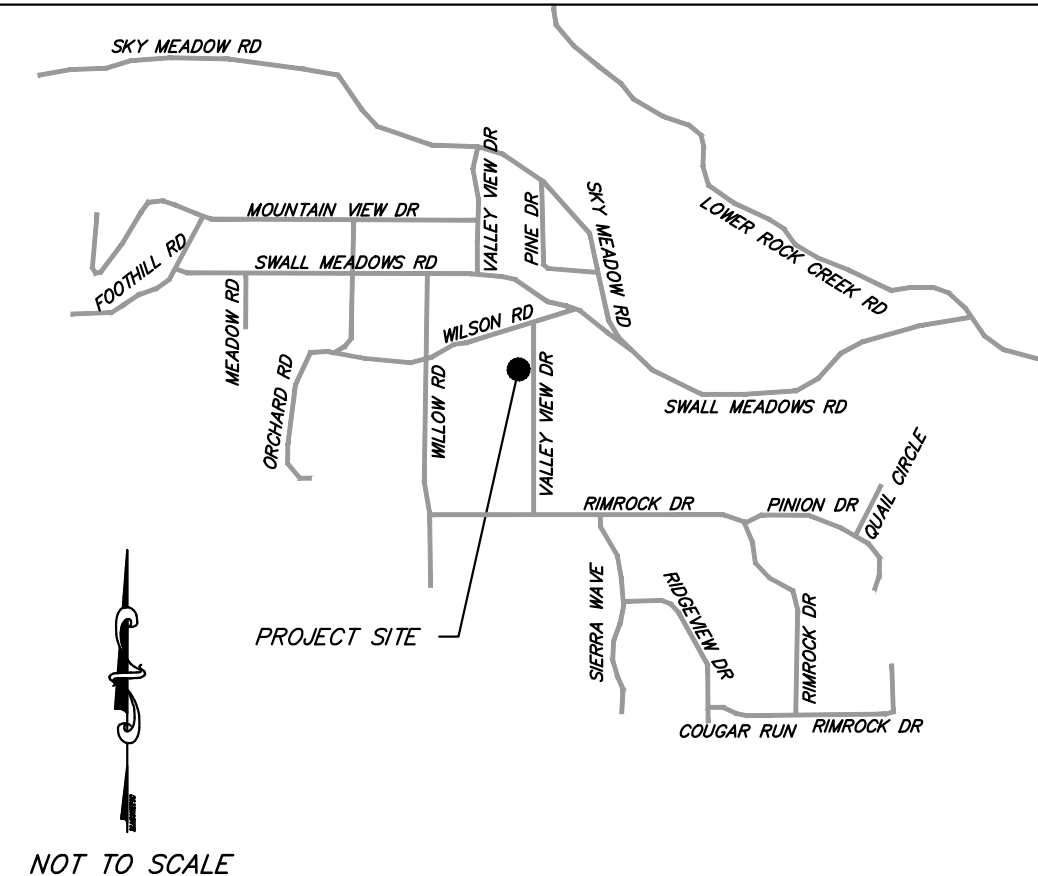

VICINITY MAP

Copyright (C) 2017 by  
Triad/Holmes Associates  
All Rights Reserved. This  
Document is intended  
only for use on the  
Project Specified in the  
Title Block. Any  
Reproduction of this  
Document or Portions of  
this Document Without  
the Express Written  
Consent of Triad/Holmes  
is Prohibited.

LEGEND

- PROPERTY LINE
- - - CENTERLINE
- - - EDGE OF PAVEMENT
- x WIRE FENCE
- WOOD FENCE
- 6.355 EXISTING GROUND CONTOUR & ELEV.
- FLOWLINE

REVISIONS: BY:

PARCEL 1, VALLEY VIEW, SWALL MEADOWS  
PRELIMINARY DRIVEWAY PLAN

PREPARED FOR: TOM HOPKINS

CONTOUR INTERVAL: 1'

GRAPHIC SCALE

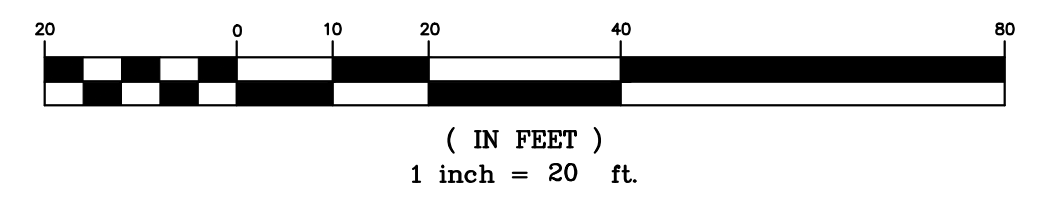

( IN FEET )  
1 inch = 20 ft.

DATE	4/4/17
SCALE	1"=20'
DRAWN	MS
JOB NO.	01.2798
DWG	1
SHEET	1 OF 1

K:\01\_Mammoth\2798\_Hopkins\_130\_Valley\_View\CAD\2798topo2.dwg Apr 11, 2017 - 10:02am, mschobler